

136

TECHNICAL REPORT

Assembly instructions for air
compressor set reference
BC00035



01 composition

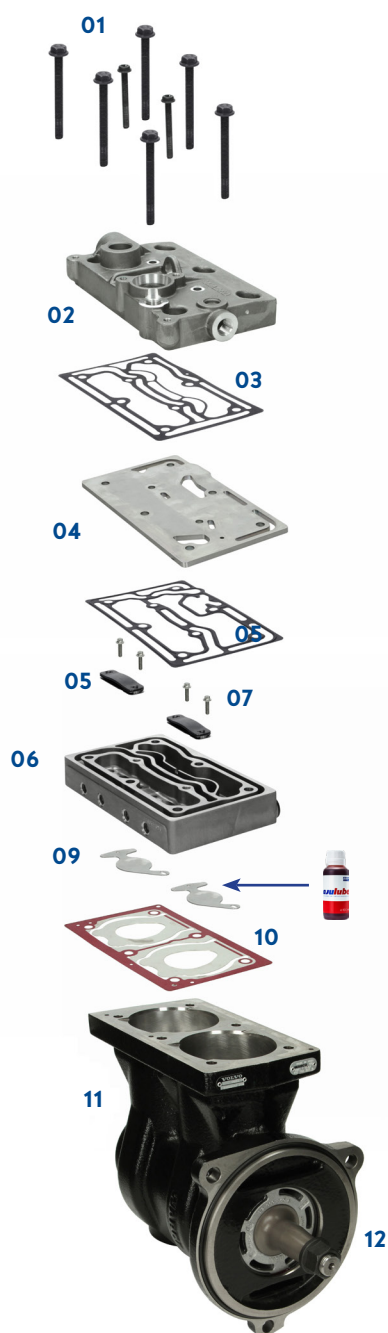

Ajusa reference BC00035

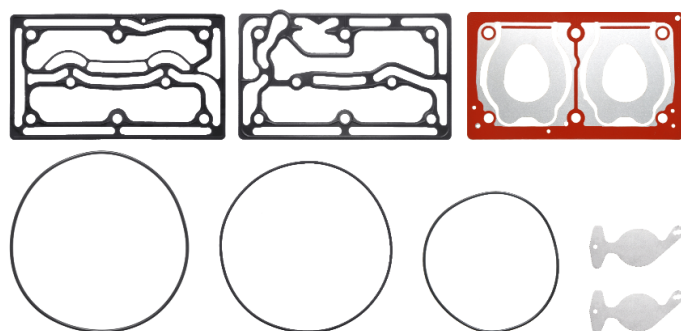

- 01. Head bolts
- 02. Valve cover
- 03. Upper valve plate gaskets | **ref. 01840500**
- 04. Valve plate
- 05. Lower valve plate gasket | **ref. 01840600**
- 06. Exhaust valve support
- 07. Valve support bolts
- 08. Valve holder
- 09. By - pass valves| **ref. 01840700**
- 10. Head compressor gasket | **ref. 01825900**
- 11. Compressor block
- 12. O-ring | **ref. 16534400**

02 recomendations

- **Disassemble** all parts of the compressor and **clean** them with an anticorrosive solvent.
- Check the **length** of the screws.
- Be sure to **clean** all housings and repair damaged threads.
- To avoid possible problems and incorrect tightening, **avoid using any type of adhesive** on the screws.
- Position the intake and exhaust valves and **lubricate** the area.
- Avoid **excessive bending** or handling of flexible valve reeds.
- If the valve support is deformed, it must **be replaced**.
- The O-rings **must be replaced** with new ones.
- When installing the O-rings must **be lubricated** to ensure tightness.
- Do **not reuse cylinder head gasket** in any case once tightened.

03 torque settings

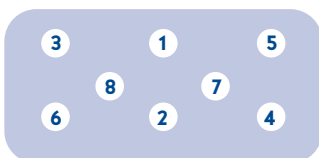

Bolts: 1, 2, 3, 4, 5, 6

- 1) 2 Kpm \pm 0,2 Kpm
- 2) 90° + 10°/-5°
- 3) 90° + 10°/-5°

Bolts: 7, 8

- 1) 0,7 Kpm \pm 0,2 Kpm
- 2) 180° + 10°/-5°



Para más información sobre la reparación del compresor, visite nuestro **canal de YouTube**, a través del código QR de la etiqueta del producto, o a través de nuestra **app Ajusa Mobile**.

